

UNIBRAKE® AC Motor Brakes



Warner Electric UNIBRAKE® Decelerates or Holds Loads When Power is Off

Page 4-9



C-Face, Power-Off Brakes

Single C-Face Power-Off Brakes are designed to decelerate or hold inertia loads when the power is turned off. The single C-Face mounts on the non-driven end of a motor. Brakes are available from 3 ft. lb. to 15 ft. lb.

Page 10-13



C-Face, Power-Off Brakes with Heavy-Duty Enclosures

Our Single C-Face Power-Off Brake is also available with cast iron housing for applications involving corrosive environments. The heavy-duty housing also includes o-ring seals to create a dust-tight brake. Brakes are available from 3 ft. lb. to 15 ft. lb.

Page 14-17



Double C-Face, Power-Off Brakes

The Double C-Face Brake is designed for use as a coupler between standard C-Face motors and C-Face gear reducers.

UNIBRAKE® is Available to Meet the Demands of a Wide Variety of Applications

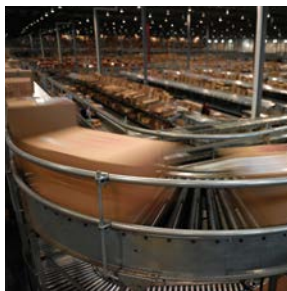

Applications

The motor brakes are commonly used as parking brakes to hold a load in place or as stopping brakes to dynamically decelerate a load. Applications include: Material Handling, Food Processing and Machine Tools.

Spring Applied — Power-Off Operation

Warner Electric spring applied motor brakes are designed to decelerate or park inertial loads when the voltage is turned off, either intentionally or accidentally, as in the case of power failure. The friction disc with the hub is coupled to the motor shaft to be braked but is capable of moving axially. When power is off, a spring force clamps the friction disc between a pressure plate and a stationary plate, hence retarding motion. When an AC voltage is applied, the solenoid creates a Direct Acting magnetic force which releases the friction disc without the use of a linkage. This allows the hub and motor shaft to turn freely.

Simple design with fewer moving parts means less downtime

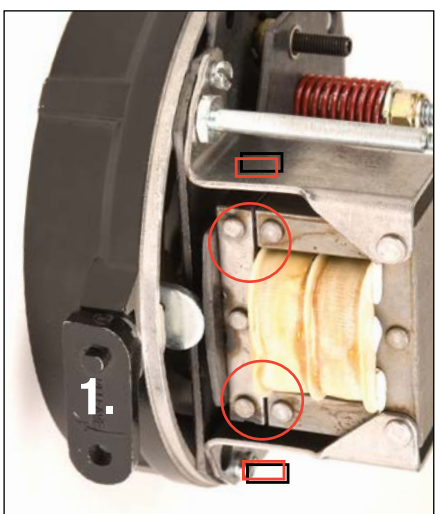

1. When the motor is 'off', the driven load can be moved without energizing the motor by rotating the manual release lever 90° clockwise which removes the retarding torque from the motor shaft.

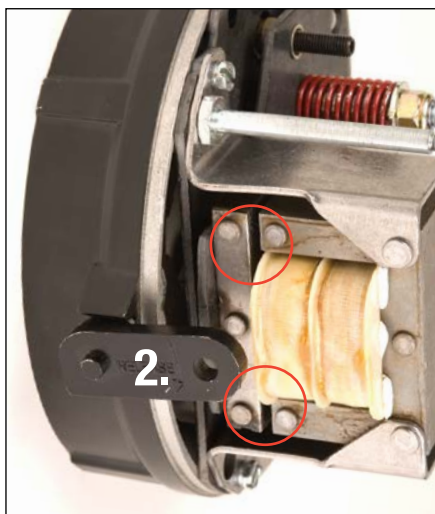

2. The lever returns to the normal "set" position when the brake is re-energized.

Features

- External manual release lever
- Totally enclosed construction
- Torque adjustable from full rated torque down to 50%
- Single phase AC coils provide fast engagement and release times and easy wiring.

Mounting

Two styles are available: the single C-Face brake and the double C-Face brake. The single C-Face mounts on the non-driven end of a motor. The C-Face brake is interchangeable with existing brakes and can be used on motors that are modified to accept a brake. The double C-Face brake can be used as a coupler between standard C-Face motors and C-Face gear reducers. All motor brakes are interchangeable with competitive motor brakes.

C-Face Power-Off Brakes

F Series AC Rear-Mounted Brakes with NEMA 2 Housing Aluminum Head-Steel Cover

56,000 NEMA 2 ; 56,100 NEMA 2 ; 56,300 NEMA 1



Warner Electric Single C-Face Power-Off Brakes are designed to decelerate or hold inertia loads when the power is turned off. The single C-Face mounts on the non-driven end of a motor. Brakes are available from 3 ft. lb. to 15 ft. lb.

Features:

- External manual release lever
- Totally enclosed construction
- Torque adjustable from full-rated torque down to 50%
- Single-phase AC coils to provide fast release times and easy wiring
- Single C-Face

Brake Part Numbers

Technical Data

| Coil Voltage | 3 ft. lb. Brakes (1 Disc) | 6 ft. lb. Brakes (1 Disc) | 10 ft. lb. Brakes (2 Discs) | 15 ft. lb. Brakes (3 Discs) | Current Holding Amps | Current Inrush Amps |
|---------------------|---------------------------------|---------------------------------|-----------------------------------|-----------------------------------|-------------------------|------------------------|
| 5/8 Bore Hub | | | | | | |
| 115/230, 60 HZ | F51A0321-W | F51A0621-W | F52A0721-W | F53A0821-W | .50/.25 | 3.66/1.83 |
| 230/460, 60 HZ | F51A0324-W | F51A0624-W | F52A0724-W | F53A0824-W | .28/.14 | 1.94/.97 |
| 287/575, 60 HZ | F51A0325-W | F51A0625-W | F52A0725-W | F53A0825-W | .22/.11 | 1.54/.77 |
| 115/230, 50 HZ | F51A0328-W | F51A0628-W | F52A0728-W | F53A0828-W | .45/.22 | 3.27/1.64 |
| 230/460, 50 HZ | F51A0329-W | F51A0629-W | F52A0729-W | F53A0829-W | .24/.12 | 1.76/.88 |
| 3/4 Bore Hub | | | | | | |
| 115/230, 60 HZ | F51B0321-W | F51B0621-W | F52B0721-W | F53B0821-W | .50/.25 | 3.66/1.83 |
| 230/460, 60 HZ | F51B0324-W | F51B0624-W | F52B0724-W | F53B0824-W | .28/.14 | 1.94/.97 |
| 287/575, 60 HZ | F51B0325-W | F51B0625-W | F52B0725-W | F53B0825-W | .22/.11 | 1.54/.77 |
| 115/230, 50 HZ | F51B0328-W | F51B0628-W | F52B0728-W | F53B0828-W | .45/.22 | 3.27/1.64 |
| 230/460, 50 HZ | F51B0329-W | F51B0629-W | F52B0729-W | F53B0829-W | .24/.12 | 1.76/.88 |
| 7/8 Bore Hub | | | | | | |
| 115/230, 60 HZ | F51C0321-W | F51C0621-W | F52C0721-W | F53C0821-W | .50/.25 | 3.66/1.83 |
| 230/460, 60 HZ | F51C0324-W | F51C0624-W | F52C0724-W | F53C0824-W | .28/.14 | 1.94/.97 |
| 287/575, 60 HZ | F51C0325-W | F51C0625-W | F52C0725-W | F53C0825-W | .22/.11 | 1.54/.77 |
| 115/230, 50 HZ | F51C0328-W | F51C0628-W | F52C0728-W | F53C0828-W | .45/.22 | 3.27/1.64 |
| 230/460, 50 HZ | F51C0329-W | F51C0629-W | F52C0729-W | F53C0829-W | .24/.12 | 1.76/.88 |

C-Face Power-Off Brakes

F Series AC Rear-Mounted Brakes with NEMA 2 Housing Aluminum Head-Steel Cover 56,000 NEMA 2

Stearns®

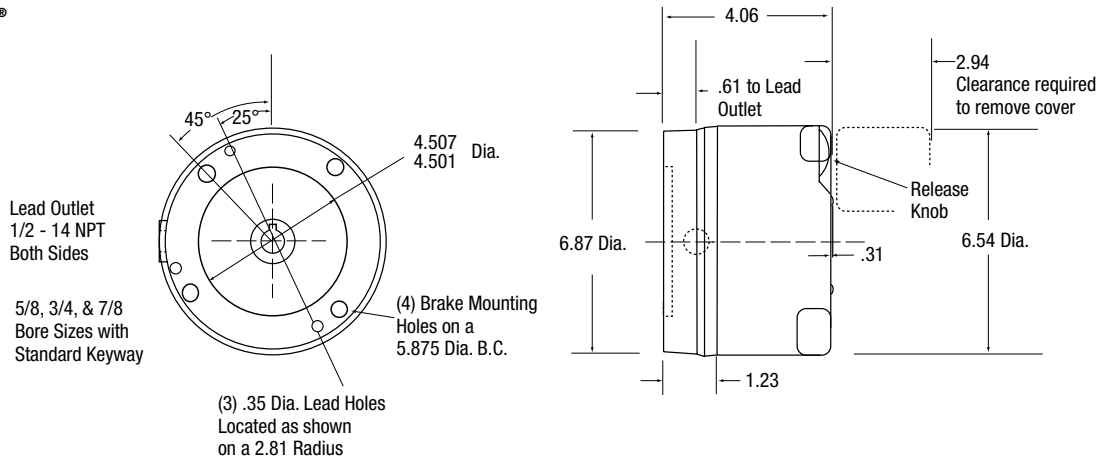

Warner UNIBRAKE®

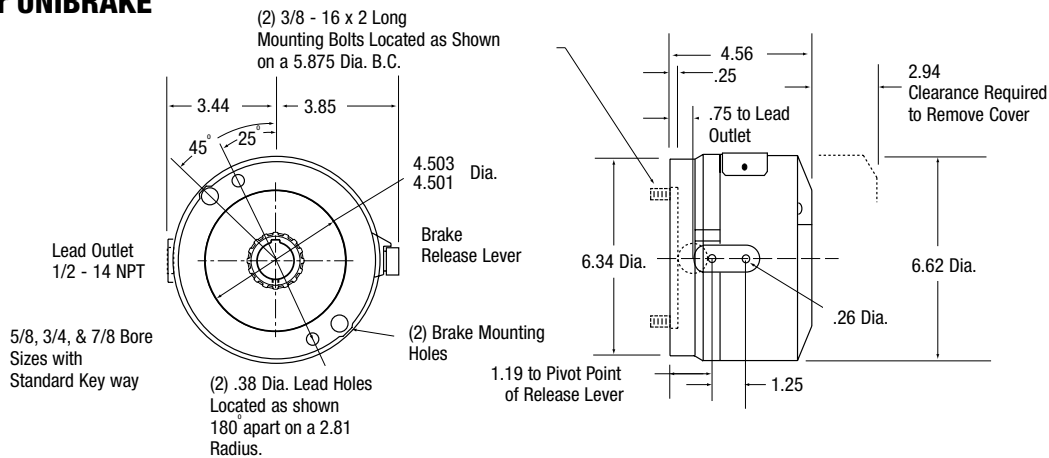

UNIBRAKE® Interchange

| Stearns® Part Number | Warner Electric Replacement | Stearns® Part Number | Warner Electric Replacement | Stearns® Part Number | Warner Electric Replacement |
|-------------------------|--------------------------------|-------------------------|--------------------------------|-------------------------|--------------------------------|
| 1-056-011-00-BNF | F51A0325-W | 1-056-021-00-CNF | F51B0625-W | 1-056-031-00-DNF | F52C0725-W |
| 1-056-011-00-BOF | F51A0328-W | 1-056-021-00-COF | F51B0628-W | 1-056-031-00-DOF | F52C0728-W |
| 1-056-011-00-BPF | F51A0321-W | 1-056-021-00-CPF | F51B0621-W | 1-056-031-00-DPF | F52C0721-W |
| 1-056-011-00-BQF | F51A0324-W | 1-056-021-00-CQF | F51B0624-W | 1-056-031-00-DQF | F52C0724-W |
| 1-056-011-00-CNF | F51B0325-W | 1-056-021-00-DNF | F51C0625-W | 1-056-041-00-BNF | F53A0825-W |
| 1-056-011-00-COF | F51B0328-W | 1-056-021-00-DOF | F51C0628-W | 1-056-041-00-BOF | F53A0828-W |
| 1-056-011-00-CPF | F51B0321-W | 1-056-021-00-DPF | F51C0621-W | 1-056-041-00-BPF | F53A0821-W |
| 1-056-011-00-CQF | F51B0324-W | 1-056-021-00-DQF | F51C0624-W | 1-056-041-00-BQF | F53A0824-W |
| 1-056-011-00-DNF | F51C0325-W | 1-056-031-00-BNF | F52A0725-W | 1-056-041-00-CNF | F53B0825-W |
| 1-056-011-00-DOF | F51C0328-W | 1-056-031-00-BOF | F52A0728-W | 1-056-041-00-COF | F53B0828-W |
| 1-056-011-00-DPF | F51C0321-W | 1-056-031-00-BPF | F52A0721-W | 1-056-041-00-CPF | F53B0821-W |
| 1-056-011-00-DQF | F51C0324-W | 1-056-031-00-BQF | F52A0724-W | 1-056-041-00-CQF | F53B0824-W |
| 1-056-021-00-BNF | F51A0625-W | 1-056-031-00-CNF | F52B0725-W | 1-056-041-00-DNF | F53C0825-W |
| 1-056-021-00-BOF | F51A0628-W | 1-056-031-00-COF | F52B0728-W | 1-056-041-00-DOF | F53C0828-W |
| 1-056-021-00-BPF | F51A0621-W | 1-056-031-00-CPF | F52B0721-W | 1-056-041-00-DPF | F53C0821-W |
| 1-056-021-00-BQF | F51A0624-W | 1-056-031-00-CQF | F52B0724-W | 1-056-041-00-DQF | F53C0824-W |

C-Face Power-Off Brakes

F Series AC Rear-Mounted Brakes with NEMA 2 Housing

Aluminum Head-Steel Cover

56,100 NEMA 2

Stearns®

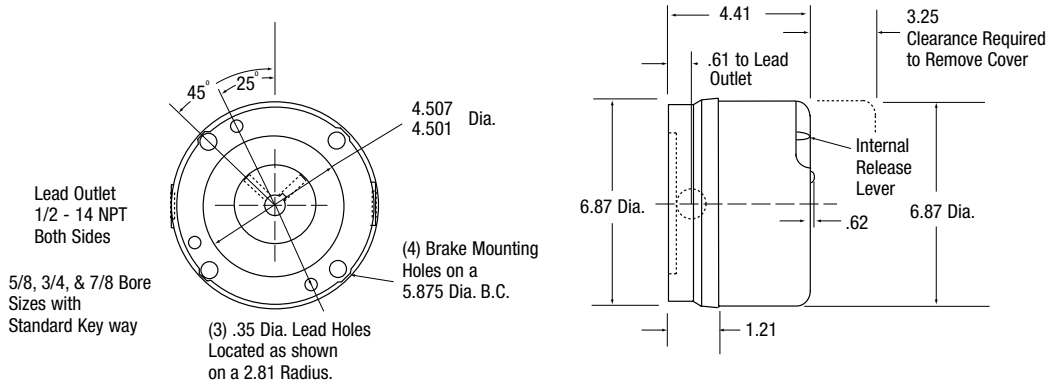

Warner UNIBRAKE®

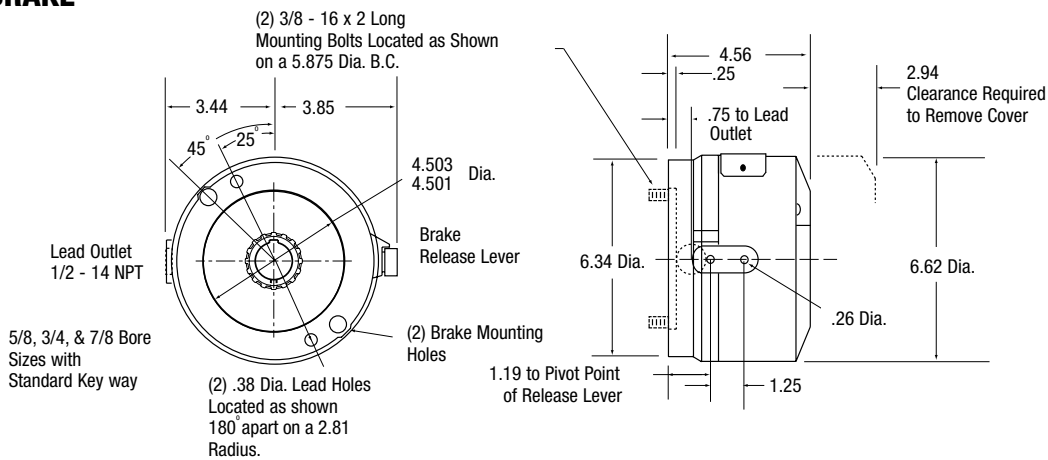

UNIBRAKE® Interchange

| Stearns® Part Number | Warner Electric Replacement | Stearns® Part Number | Warner Electric Replacement | Stearns® Part Number | Warner Electric Replacement |
|-------------------------|--------------------------------|-------------------------|--------------------------------|-------------------------|--------------------------------|
| 1-056-111-00-BNF | F51A0325-W | 1-056-121-00-CNF | F51B0625-W | 1-056-131-00-DNF | F52C0725-W |
| 1-056-111-00-BOF | F51A0328-W | 1-056-121-00-COF | F51B0628-W | 1-056-131-00-DOF | F52C0728-W |
| 1-056-111-00-BPF | F51A0321-W | 1-056-121-00-CPF | F51B0621-W | 1-056-131-00-DPF | F52C0721-W |
| 1-056-111-00-BQF | F51A0324-W | 1-056-121-00-CQF | F51B0624-W | 1-056-131-00-DQF | F52C0724-W |
| 1-056-111-00-CNF | F51B0325-W | 1-056-121-00-DNF | F51C0625-W | 1-056-141-00-BNF | F53A0825-W |
| 1-056-111-00-COF | F51B0328-W | 1-056-121-00-DOF | F51C0628-W | 1-056-141-00-BOF | F53A0828-W |
| 1-056-111-00-CPF | F51B0321-W | 1-056-121-00-DPF | F51C0621-W | 1-056-141-00-BPF | F53A0821-W |
| 1-056-111-00-CQF | F51B0324-W | 1-056-121-00-DQF | F51C0624-W | 1-056-141-00-BQF | F53A0824-W |
| 1-056-111-00-DNF | F51C0325-W | 1-056-131-00-BNF | F52A0725-W | 1-056-141-00-CNF | F53B0825-W |
| 1-056-111-00-DOF | F51C0328-W | 1-056-131-00-BOF | F52A0728-W | 1-056-141-00-COF | F53B0828-W |
| 1-056-111-00-DPF | F51C0321-W | 1-056-131-00-BPF | F52A0721-W | 1-056-141-00-CPF | F53B0821-W |
| 1-056-111-00-DQF | F51C0324-W | 1-056-131-00-BQF | F52A0724-W | 1-056-141-00-CQF | F53B0824-W |
| 1-056-121-00-BNF | F51A0625-W | 1-056-131-00-CNF | F52B0725-W | 1-056-141-00-DNF | F53C0825-W |
| 1-056-121-00-BOF | F51A0628-W | 1-056-131-00-COF | F52B0728-W | 1-056-141-00-DOF | F53C0828-W |
| 1-056-121-00-BPF | F51A0621-W | 1-056-131-00-CPF | F52B0721-W | 1-056-141-00-DPF | F53C0821-W |
| 1-056-121-00-BQF | F51A0624-W | 1-056-131-00-CQF | F52B0724-W | 1-056-141-00-DQF | F53C0824-W |

C-Face Power-Off Brakes

F Series AC Rear-Mounted Brakes with NEMA 1 Housing

Aluminum Head-Steel Cover

56,300 NEMA 1

Stearns®

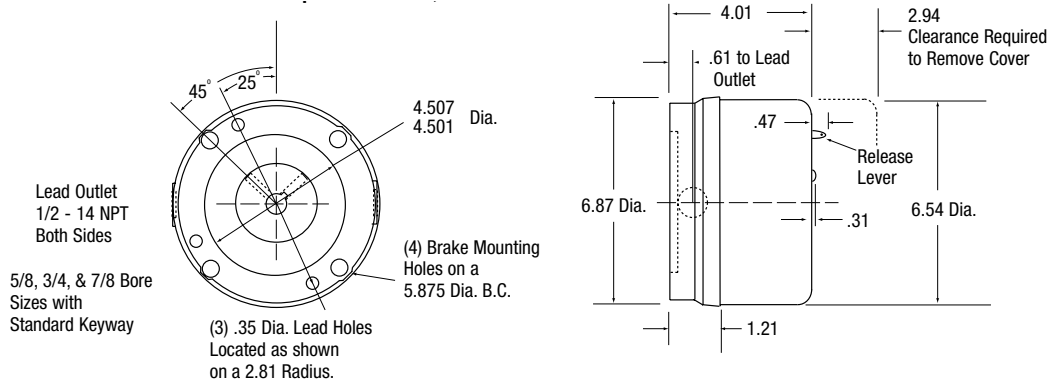

Warner UNIBRAKE®

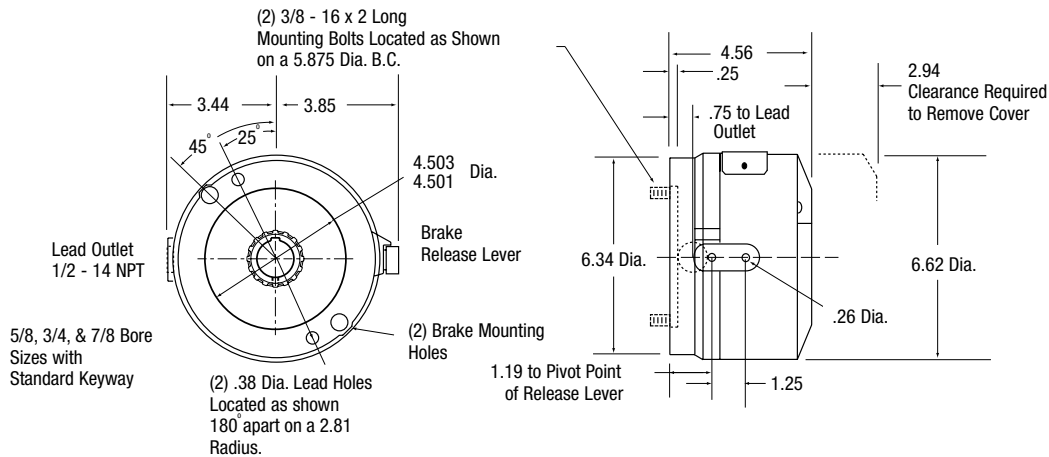

UNIBRAKE® Interchange

| Stearns® Part Number | Warner Electric Replacement | Stearns® Part Number | Warner Electric Replacement | Stearns® Part Number | Warner Electric Replacement |
|-------------------------|--------------------------------|-------------------------|--------------------------------|-------------------------|--------------------------------|
| 1-056-311-00-BNF | F51A0325-W | 1-056-321-00-CNF | F51B0625-W | 1-056-331-00-DNF | F52C0725-W |
| 1-056-311-00-BOF | F51A0328-W | 1-056-321-00-COF | F51B0628-W | 1-056-331-00-DOF | F52C0728-W |
| 1-056-311-00-BPF | F51A0321-W | 1-056-321-00-CPF | F51B0621-W | 1-056-331-00-DPF | F52C0721-W |
| 1-056-311-00-BQF | F51A0324-W | 1-056-321-00-CQF | F51B0624-W | 1-056-331-00-DQF | F52C0724-W |
| 1-056-311-00-CNF | F51B0325-W | 1-056-321-00-DNF | F51C0625-W | 1-056-341-00-BNF | F53A0825-W |
| 1-056-311-00-COF | F51B0328-W | 1-056-321-00-DOF | F51C0628-W | 1-056-341-00-BOF | F53A0828-W |
| 1-056-311-00-CPF | F51B0321-W | 1-056-321-00-DPF | F51C0621-W | 1-056-341-00-BPF | F53A0821-W |
| 1-056-311-00-CQF | F51B0324-W | 1-056-321-00-DQF | F51C0624-W | 1-056-341-00-BQF | F53A0824-W |
| 1-056-311-00-DNF | F51C0325-W | 1-056-331-00-BNF | F52A0725-W | 1-056-341-00-CNF | F53B0825-W |
| 1-056-311-00-DOF | F51C0328-W | 1-056-331-00-BOF | F52A0728-W | 1-056-341-00-COF | F53B0828-W |
| 1-056-311-00-DPF | F51C0321-W | 1-056-331-00-BPF | F52A0721-W | 1-056-341-00-CPF | F53B0821-W |
| 1-056-311-00-DQF | F51C0324-W | 1-056-331-00-BQF | F52A0724-W | 1-056-341-00-CQF | F53B0824-W |
| 1-056-321-00-BNF | F51A0625-W | 1-056-331-00-CNF | F52B0725-W | 1-056-341-00-DNF | F53C0825-W |
| 1-056-321-00-BOF | F51A0628-W | 1-056-331-00-COF | F52B0728-W | 1-056-341-00-DOF | F53C0828-W |
| 1-056-321-00-BPF | F51A0621-W | 1-056-331-00-CPF | F52B0721-W | 1-056-341-00-DPF | F53C0821-W |
| 1-056-321-00-BQF | F51A0624-W | 1-056-331-00-CQF | F52B0724-W | 1-056-341-00-DQF | F53C0824-W |

C-Face Power-Off Brakes

F Series AC Rear-Mounted Brakes with NEMA 2 Housing

Cast Iron Head-Steel Cover

56,400 NEMA 2



Warner Electric Single C-Face Power-Off Brakes are designed to decelerate or hold inertia loads when the power is turned off. The single C-Face mounts on the non-driven end of a motor. Brakes are available from 3 ft. lb. to 15 ft. lb.

Features:

- External manual release lever
- Totally enclosed construction
- Torque adjustable from full-rated torque down to 50%
- Single-phase AC coils to provide fast release times and easy wiring
- Single C-Face

Brake Part Numbers

Technical Data

| Coil Voltage | 3 ft. lb. Brakes (1 Disc) | 6 ft. lb. Brakes (1 Disc) | 10 ft. lb. Brakes (2 Discs) | 15 ft. lb. Brakes (3 Discs) | Current Holding Amps | Current Inrush Amps |
|---------------------|---------------------------|---------------------------|-----------------------------|-----------------------------|----------------------|---------------------|
| 5/8 Bore Hub | | | | | | |
| 115/230, 60 HZ | F51A7321-W | F51A7621-W | F52A7721-W | F53A7821-W | .50/.25 | 3.66/1.83 |
| 230/460, 60 HZ | F51A7324-W | F51A7624-W | F52A7724-W | F53A7824-W | .28/.14 | 1.94/.97 |
| 287/575, 60 HZ | F51A7325-W | F51A7625-W | F52A7725-W | F53A7825-W | .22/.11 | 1.54/.77 |
| 115/230, 50 HZ | F51A7328-W | F51A7628-W | F52A7728-W | F53A7828-W | .45/.22 | 3.27/1.64 |
| 230/460, 50 HZ | F51A7329-W | F51A7629-W | F52A7729-W | F53A7829-W | .24/.12 | 1.76/.88 |
| 3/4 Bore Hub | | | | | | |
| 115/230, 60 HZ | F51B7321-W | F51B7621-W | F52B7721-W | F53B7821-W | .50/.25 | 3.66/1.83 |
| 230/460, 60 HZ | F51B7324-W | F51B7624-W | F52B7724-W | F53B7824-W | .28/.14 | 1.94/.97-W |
| 287/575, 60 HZ | F51B7325-W | F51B7625-W | F52B7725-W | F53B7825-W | .22/.11 | 1.54/.77 |
| 115/230, 50 HZ | F51B7328-W | F51B7628-W | F52B7728-W | F53B7828-W | .45/.22 | 3.27/1.64 |
| 230/460, 50 HZ | F51B7329-W | F51B7629-W | F52B7729-W | F53B7829-W | .24/.12 | 1.76/.88 |
| 7/8 Bore Hub | | | | | | |
| 115/230, 60 HZ | F51C7321-W | F51C7621-W | F52C7721-W | F53C7821-W | .50/.25 | 3.66/1.83 |
| 230/460, 60 HZ | F51C7324-W | F51C7624-W | F52C7724-W | F53C7824-W | .28/.14 | 1.94/.97 |
| 287/575, 60 HZ | F51C7325-W | F51C7625-W | F52C7725-W | F53C7825-W | .22/.11 | 1.54/.77 |
| 115/230, 50 HZ | F51C7328-W | F51C7628-W | F52C7728-W | F53C7828-W | .45/.22 | 3.27/1.64 |
| 230/460, 50 HZ | F51C7329-W | F51C7629-W | F52C7729-W | F53C7829-W | .24/.12 | 1.76/.88 |

C-Face Power-Off Brakes

F Series AC Rear-Mounted Brakes with NEMA 2 Housing Cast Iron Head-Steel Cover

56,400 NEMA 2

Stearns®

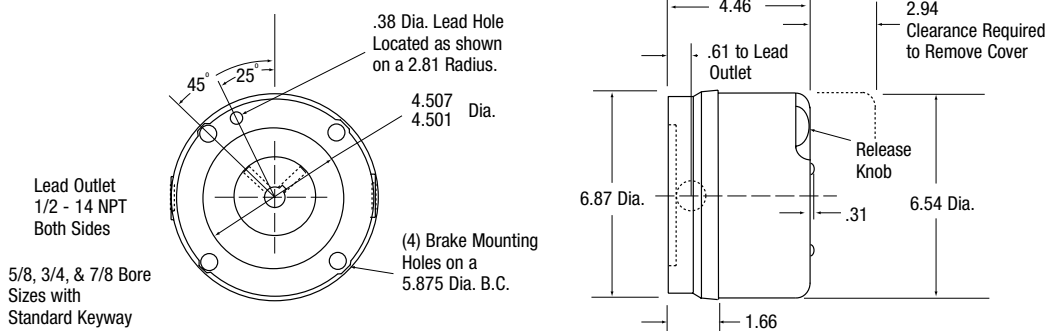

Warner UNIBRAKE®

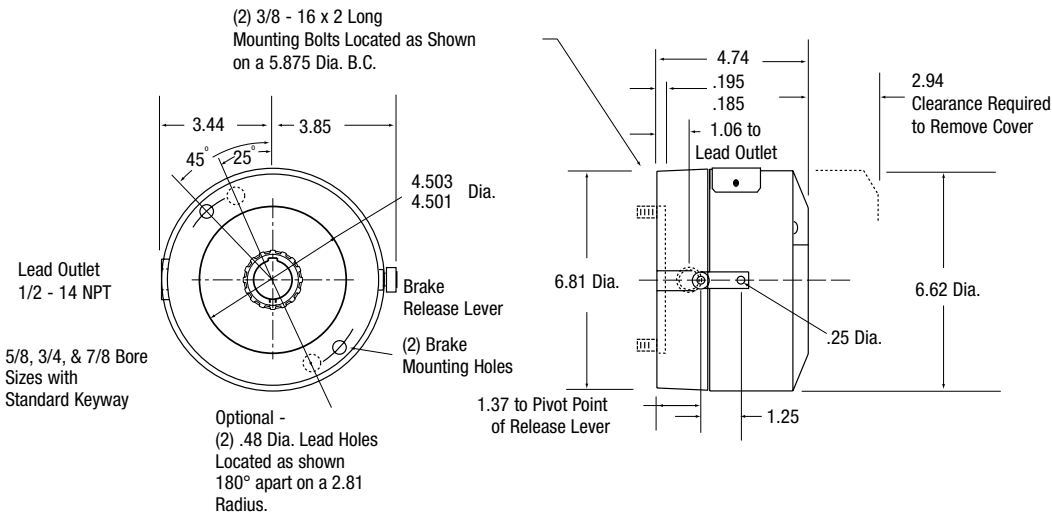

UNIBRAKE® Interchange

| Stearns® Part Number | Warner Electric Replacement | Stearns® Part Number | Warner Electric Replacement | Stearns® Part Number | Warner Electric Replacement |
|----------------------|-----------------------------|----------------------|-----------------------------|----------------------|-----------------------------|
| 1-056-331-00-DNF | F52C0725-W | 1-056-421-00-CNF | F51B7625-W | 1-056-431-00-DNF | F52C7725-W |
| 1-056-331-00-DOF | F52C0728-W | 1-056-421-00-COF | F51B7628-W | 1-056-431-00-DOF | F52C7728-W |
| 1-056-331-00-DPF | F52C0721-W | 1-056-421-00-CPF | F51B7621-W | 1-056-431-00-DPF | F52C7721-W |
| 1-056-331-00-DQF | F52C0724-W | 1-056-421-00-CQF | F51B7624-W | 1-056-431-00-DQF | F52C7724-W |
| 1-056-341-00-BNF | F53A0825-W | 1-056-421-00-DNF | F51C7625-W | 1-056-441-00-BNF | F53A7825-W |
| 1-056-341-00-BOF | F53A0828-W | 1-056-421-00-DOF | F51C7628-W | 1-056-441-00-BOF | F53A7828-W |
| 1-056-341-00-BPF | F53A0821-W | 1-056-421-00-DPF | F51C7621-W | 1-056-441-00-BPF | F53A7821-W |
| 1-056-341-00-BQF | F53A0824-W | 1-056-421-00-DQF | F51C7624-W | 1-056-441-00-BQF | F53A7824-W |
| 1-056-341-00-CNF | F53B0825-W | 1-056-431-00-BNF | F52A7725-W | 1-056-441-00-CNF | F53B7825-W |
| 1-056-341-00-COF | F53B0828-W | 1-056-431-00-BOF | F52A7728-W | 1-056-441-00-COF | F53B7828-W |
| 1-056-341-00-CPF | F53B0821-W | 1-056-431-00-BPF | F52A7721-W | 1-056-441-00-CPF | F53B7821-W |
| 1-056-341-00-CQF | F53B0824-W | 1-056-431-00-BQF | F52A7724-W | 1-056-441-00-CQF | F53B7824-W |
| 1-056-341-00-DNF | F53C0825-W | 1-056-431-00-CNF | F52B7725-W | 1-056-441-00-DNF | F53C7825-W |
| 1-056-341-00-DOF | F53C0828-W | 1-056-431-00-COF | F52B7728-W | 1-056-441-00-DOF | F53C7828-W |
| 1-056-341-00-DPF | F53C0821-W | 1-056-431-00-CPF | F52B7721-W | 1-056-441-00-DPF | F53C7821-W |
| 1-056-341-00-DQF | F53C0824-W | 1-056-431-00-CQF | F52B7724-W | 1-056-441-00-DQF | F53C7824-W |

C-Face Power-Off Brakes with Heavy-Duty Enclosures

F Series AC Rear-Mounted Brakes with NEMA 2 Housing

Cast Iron Head and Cover

56,200 NEMA 2



Warner Electric Single C-Face Power-Off Brake is also available with cast iron housing for applications involving corrosive environments. Brakes are available from 3 ft. lb. to 15 ft. lb.

Features:

- External manual release lever
- Totally enclosed construction
- Torque adjustable from full-rated torque down to 50%
- Single-phase AC coils to provide fast release times and easy wiring
- Single C-Face

Brake Part Numbers

Technical Data

| Coil Voltage | 3 ft. lb. Brakes (1 Disc) | 6 ft. lb. Brakes (1 Disc) | 10 ft. lb. Brakes (2 Discs) | 15 ft. lb. Brakes (3 Discs) | Current Holding Amps | Current Inrush Amps |
|---------------------|---------------------------|---------------------------|-----------------------------|-----------------------------|----------------------|---------------------|
| 5/8 Bore Hub | | | | | | |
| 115/230, 60 HZ | F51A8311-W | F51A8611-W | F52A8711-W | F53A8811-W | .50/.25 | 3.66/1.83 |
| 230/460, 60 HZ | F51A8314-W | F51A8614-W | F52A8714-W | F53A8814-W | .28/.14 | 1.94/.97 |
| 287/575, 60 HZ | F51A8315-W | F51A8615-W | F52A8715-W | F53A8815-W | .22/.11 | 1.54/.77 |
| 115/230, 50 HZ | F51A8318-W | F51A8618-W | F52A8718-W | F53A8818-W | .45/.22 | 3.27/1.64 |
| 230/460, 50 HZ | F51A8319-W | F51A8619-W | F52A8719-W | F53A8819-W | .24/.12 | 1.76/.88 |
| 3/4 Bore Hub | | | | | | |
| 115/230, 60 HZ | F51B8311-W | F51B8611-W | F52B8711-W | F53B8811-W | .50/.25 | 3.66/1.83 |
| 230/460, 60 HZ | F51B8314-W | F51B8614-W | F52B8714-W | F53B8814-W | .28/.14 | 1.94/.97 |
| 287/575, 60 HZ | F51B8315-W | F51B8615-W | F52B8715-W | F53B8815-W | .22/.11 | 1.54/.77 |
| 115/230, 50 HZ | F51B8318-W | F51B8618-W | F52B8718-W | F53B8818-W | .45/.22 | 3.27/1.64 |
| 230/460, 50 HZ | F51B8319-W | F51B8619-W | F52B8719-W | F53B8819-W | .24/.12 | 1.76/.88 |
| 7/8 Bore Hub | | | | | | |
| 115/230, 60 HZ | F51C8311-W | F51C8611-W | F52C8711-W | F53C8811-W | .50/.25 | 3.66/1.83 |
| 230/460, 60 HZ | F51C8314-W | F51C8614-W | F52C8714-W | F53C8814-W | .28/.14 | 1.94/.97 |
| 287/575, 60 HZ | F51C8315-W | F51C8615-W | F52C8715-W | F53C8815-W | .22/.11 | 1.54/.77 |
| 115/230, 50 HZ | F51C8318-W | F51C8618-W | F52C8718-W | F53C8818-W | .45/.22 | 3.27/1.64 |
| 230/460, 50 HZ | F51C8319-W | F51C8619-W | F52C8719-W | F53C8819-W | .24/.12 | 1.76/.88 |

C-Face Power-Off Brakes with Heavy-Duty Enclosures

F Series AC Rear-Mounted Brakes with NEMA 2 Housing

Cast Iron Head and Cover

56,200 NEMA 2

Stearns®

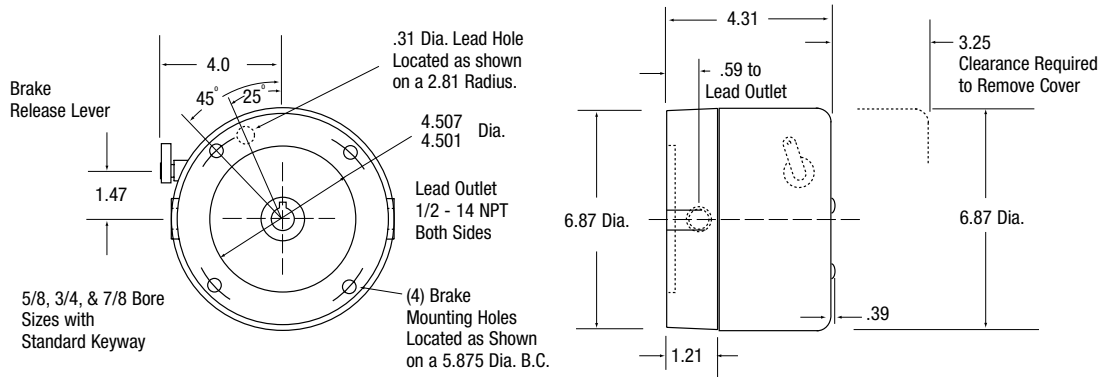

Warner UNIBRAKE®

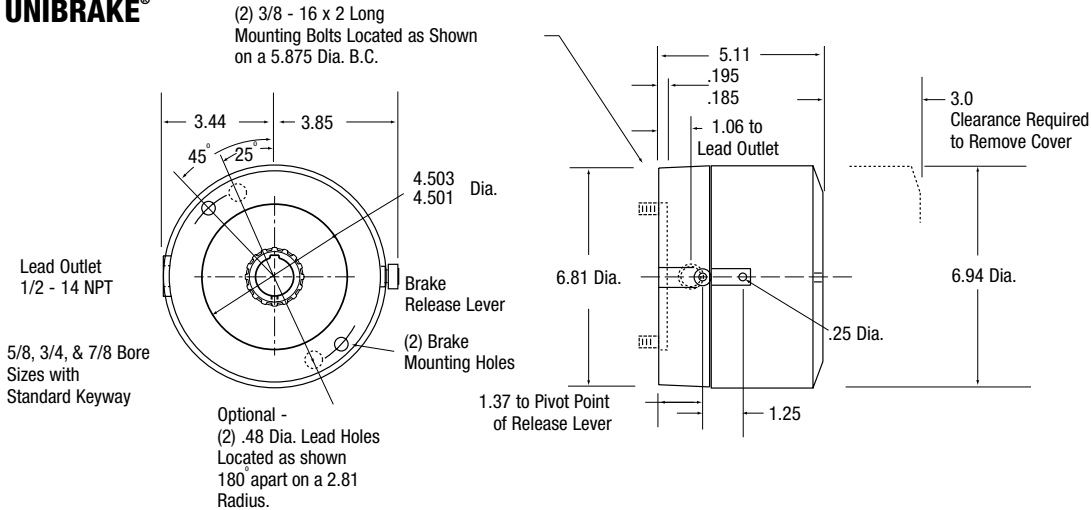

UNIBRAKE® Interchange

| Stearns® Part Number | Warner Electric Replacement | Stearns® Part Number | Warner Electric Replacement | Stearns® Part Number | Warner Electric Replacement |
|----------------------|-----------------------------|----------------------|-----------------------------|----------------------|-----------------------------|
| 1-056-211-00-BNF | F51A8315-W | 1-056-221-00-CNF | F51B8615-W | 1-056-231-00-DNF | F52C8715-W |
| 1-056-211-00-BOF | F51A8318-W | 1-056-221-00-COF | F51B8618-W | 1-056-231-00-DOF | F52C8718-W |
| 1-056-211-00-BPF | F51A8311-W | 1-056-221-00-CPF | F51B8611-W | 1-056-231-00-DPF | F52C8711-W |
| 1-056-211-00-BQF | F51A8314-W | 1-056-221-00-CQF | F51B8614-W | 1-056-231-00-DQF | F52C8714-W |
| 1-056-211-00-CNF | F51B8315-W | 1-056-221-00-DNF | F51C8615-W | 1-056-241-00-BNF | F53A8815-W |
| 1-056-211-00-COF | F51B8318-W | 1-056-221-00-DOF | F51C8618-W | 1-056-241-00-BOF | F53A8818-W |
| 1-056-211-00-CPF | F51B8311-W | 1-056-221-00-DPF | F51C8611-W | 1-056-241-00-BPF | F53A8811-W |
| 1-056-211-00-CQF | F51B8314-W | 1-056-221-00-DQF | F51C8614-W | 1-056-241-00-BQF | F53A8814-W |
| 1-056-211-00-DNF | F51C8315-W | 1-056-231-00-BNF | F52A8715-W | 1-056-241-00-CNF | F53B8815-W |
| 1-056-211-00-DOF | F51C8318-W | 1-056-231-00-BOF | F52A8718-W | 1-056-241-00-COF | F53B8818-W |
| 1-056-211-00-DPF | F51C8311-W | 1-056-231-00-BPF | F52A8711-W | 1-056-241-00-CPF | F53B8811-W |
| 1-056-211-00-DQF | F51C8314-W | 1-056-231-00-BQF | F52A8714-W | 1-056-241-00-CQF | F53B8814-W |
| 1-056-221-00-BNF | F51A8615-W | 1-056-231-00-CNF | F52B8715-W | 1-056-241-00-DNF | F53C8815-W |
| 1-056-221-00-BOF | F51A8618-W | 1-056-231-00-COF | F52B8718-W | 1-056-241-00-DOF | F53C8818-W |
| 1-056-221-00-BPF | F51A8611-W | 1-056-231-00-CPF | F52B8711-W | 1-056-241-00-DPF | F53C8811-W |
| 1-056-221-00-BQF | F51A8614-W | 1-056-231-00-CQF | F52B8714-W | 1-056-241-00-DQF | F53C8814-W |

C-Face Power-Off Brakes with Heavy-Duty Enclosures

F Series AC Rear-Mounted Brakes with NEMA 4 Housing

Cast Iron Head and Cover

56,200 NEMA 4



Warner Electric Single C-Face Power-Off Brake is also available with cast iron housing for applications involving corrosive environments. The heavy-duty housing also includes o-ring seals to create a dust-tight brake. Brakes are available from 3 ft. lb. to 15 ft. lb.

Features:

- External manual release lever
- Totally enclosed construction
- Torque adjustable from full-rated torque down to 50%
- Single-phase AC coils to provide fast release times and easy wiring
- Single C-Face

Brake Part Numbers

Technical Data

| Coil Voltage | 3 ft. lb. Brakes (1 Disc) | 6 ft. lb. Brakes (1 Disc) | 10 ft. lb. Brakes (2 Discs) | 15 ft. lb. Brakes (3 Discs) | Current Holding Amps | Current Inrush Amps |
|---------------------|---------------------------|---------------------------|-----------------------------|-----------------------------|----------------------|---------------------|
| 5/8 Bore Hub | | | | | | |
| 115/230, 60 HZ | F51A1311-W | F51A1611-W | F52A1711-W | F53A1811-W | .50/.25 | 3.66/1.83 |
| 230/460, 60 HZ | F51A1314-W | F51A1614-W | F52A1714-W | F53A1814-W | .28/.14 | 1.94/.97 |
| 287/575, 60 HZ | F51A1315-W | F51A1615-W | F52A1715-W | F53A1815-W | .22/.11 | 1.54/.77 |
| 115/230, 50 HZ | F51A1318-W | F51A1618-W | F52A1718-W | F53A1818-W | .45/.22 | 3.27/1.64 |
| 230/460, 50 HZ | F51A1319-W | F51A1619-W | F52A1719-W | F53A1819-W | .24/.12 | 1.76/.88 |
| 3/4 Bore Hub | | | | | | |
| 115/230, 60 HZ | F51B1311-W | F51B1611-W | F52B1711-W | F53B1811-W | .50/.25 | 3.66/1.83 |
| 230/460, 60 HZ | F51B1314-W | F51B1614-W | F52B1714-W | F53B1814-W | .28/.14 | 1.94/.97 |
| 287/575, 60 HZ | F51B1315-W | F51B1615-W | F52B1715-W | F53B1815-W | .22/.11 | 1.54/.77 |
| 115/230, 50 HZ | F51B1318-W | F51B1618-W | F52B1718-W | F53B1818-W | .45/.22 | 3.27/1.64 |
| 230/460, 50 HZ | F51B1319-W | F51B1619-W | F52B1719-W | F53B1819-W | .24/.12 | 1.76/.88 |
| 7/8 Bore Hub | | | | | | |
| 115/230, 60 HZ | F51C1311-W | F51C1611-W | F52C1711-W | F53C1811-W | .50/.25 | 3.66/1.83 |
| 230/460, 60 HZ | F51C1314-W | F51C1614-W | F52C1714-W | F53C1814-W | .28/.14 | 1.94/.97 |
| 287/575, 60 HZ | F51C1315-W | F51C1615-W | F52C1715-W | F53C1815-W | .22/.11 | 1.54/.77 |
| 115/230, 50 HZ | F51C1318-W | F51C1618-W | F52C1718-W | F53C1818-W | .45/.22 | 3.27/1.64 |
| 230/460, 50 HZ | F51C1319-W | F51C1619-W | F52C1719-W | F53C1819-W | .24/.12 | 1.76/.88 |

C-Face Power-Off Brakes with Heavy-Duty Enclosures

F Series AC Rear-Mounted Brakes with NEMA 4 Housing Cast Iron Head and Cover

56,200 NEMA 4

Stearns®

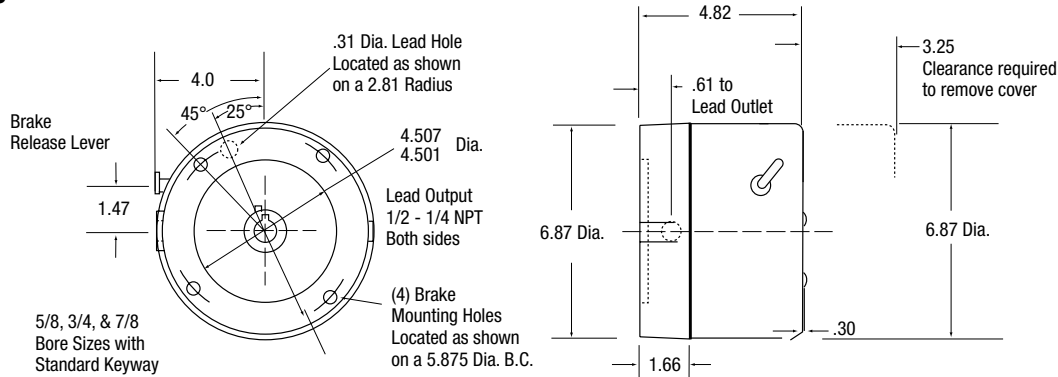

Warner UNIBRAKE®

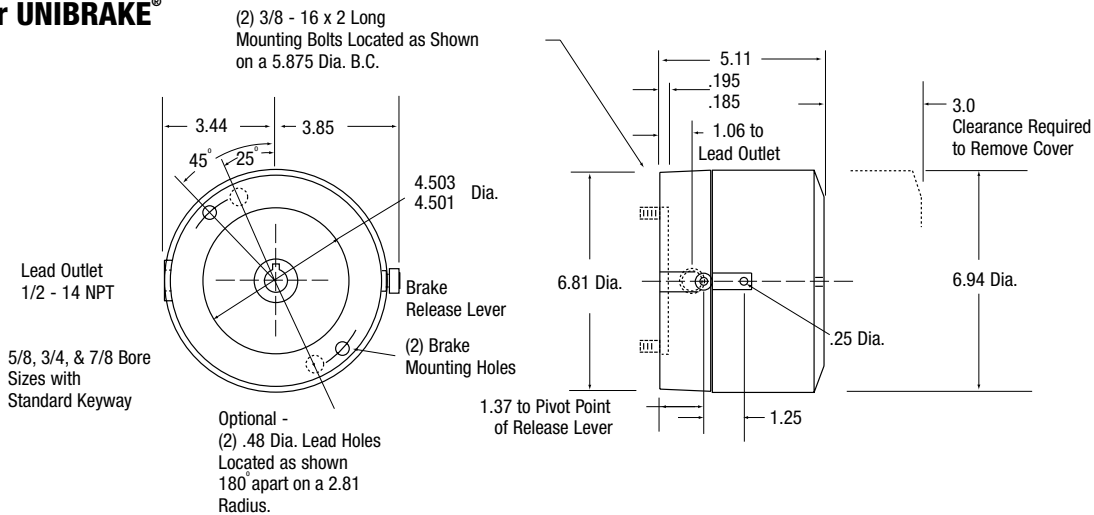

UNIBRAKE® Interchange

| Stearns® Part Number | Warner Electric Replacement | Stearns® Part Number | Warner Electric Replacement | Stearns® Part Number | Warner Electric Replacement |
|----------------------|-----------------------------|----------------------|-----------------------------|----------------------|-----------------------------|
| 1-056-212-00-BNF | F51A1315-W | 1-056-222-00-CNF | F51B1615-W | 1-056-232-00-DNF | F52C1715-W |
| 1-056-212-00-BOF | F51A1318-W | 1-056-222-00-COF | F51B1618-W | 1-056-232-00-DOF | F52C1718-W |
| 1-056-212-00-BPF | F51A1311-W | 1-056-222-00-CPF | F51B1611-W | 1-056-232-00-DPF | F52C1711-W |
| 1-056-212-00-BQF | F51A1314-W | 1-056-222-00-CQF | F51B1614-W | 1-056-232-00-DQF | F52C1714-W |
| 1-056-212-00-CNF | F51B1315-W | 1-056-222-00-DNF | F51C1615-W | 1-056-242-00-BNF | F53A1815-W |
| 1-056-212-00-COF | F51B1318-W | 1-056-222-00-DOF | F51C1618-W | 1-056-242-00-BOF | F53A1818-W |
| 1-056-212-00-CPF | F51B1311-W | 1-056-222-00-DPF | F51C1611-W | 1-056-242-00-BPF | F53A1811-W |
| 1-056-212-00-CQF | F51B1314-W | 1-056-222-00-DQF | F51C1614-W | 1-056-242-00-BQF | F53A1814-W |
| 1-056-212-00-DNF | F51C1315-W | 1-056-232-00-BNF | F52A1715-W | 1-056-242-00-CNF | F53B1815-W |
| 1-056-212-00-DOF | F51C1318-W | 1-056-232-00-BOF | F52A1718-W | 1-056-242-00-COF | F53B1818-W |
| 1-056-212-00-DPF | F51C1311-W | 1-056-232-00-BPF | F52A1711-W | 1-056-242-00-CPF | F53B1811-W |
| 1-056-212-00-DQF | F51C1314-W | 1-056-232-00-BQF | F52A1714-W | 1-056-242-00-CQF | F53B1814-W |
| 1-056-222-00-BNF | F51A1615-W | 1-056-232-00-CNF | F52B1715-W | 1-056-242-00-DNF | F53C1815-W |
| 1-056-222-00-BOF | F51A1618-W | 1-056-232-00-COF | F52B1718-W | 1-056-242-00-DOF | F53C1818-W |
| 1-056-222-00-BPF | F51A1611-W | 1-056-232-00-CPF | F52B1711-W | 1-056-242-00-DPF | F53C1811-W |
| 1-056-222-00-BQF | F51A1614-W | 1-056-232-00-CQF | F52B1714-W | 1-056-242-00-DQF | F53C1814-W |

Double C-Face Power-Off Brakes

M Series AC Coupler Brakes with NEMA 2 Housing

Aluminum Head and Cover

56,700 NEMA 2



The Double C-Face Brake is designed for use as a coupler between standard C-Face motors and C-Face gear reducers.

Features:

- External manual release lever
- Totally enclosed construction
- Torque adjustable from full-rated torque down to 50%
- Single-phase AC coils to provide fast release times and easy wiring

Brake Part Numbers

Technical Data

| Coil Voltage | 3 ft. lb. Brakes (1 Disc) | 6 ft. lb. Brakes (1 Disc) | 10 ft. lb. Brakes (2 Discs) | Current Holding Amps | Current Inrush Amps |
|---------------------------------------|---------------------------------|---------------------------------|-----------------------------------|-------------------------|------------------------|
| 5/8 Bore Shaft and Hub (56C) | | | | | |
| 115/230, 60 HZ | M51A0321-W | M51A0621-W | M52A0721-W | .50/.25 | 3.66/1.83 |
| 230/460, 60 HZ | M51A0324-W | M51A0624-W | M52A0724-W | .28/.14 | 1.94/.97 |
| 287/575, 60 HZ | M51A0325-W | M51A0625-W | M52A0725-W | .22/.11 | 1.54/.77 |
| 115/230, 50 HZ | M51A0328-W | M51A0628-W | M52A0728-W | .45/.22 | 3.27/1.64 |
| 230/460, 50 HZ | M51A0329-W | M51A0629-W | M52A0729-W | .24/.12 | 1.76/.88 |
| 7/8 Bore Shaft and Hub (145TC) | | | | | |
| 115/230, 60 HZ | M51C0321-W | M51C0621-W | M52C0721-W | .50/.25 | 3.66/1.83 |
| 230/460, 60 HZ | M51C0324-W | M51C0624-W | M52C0724-W | .28/.14 | 1.94/.97 |
| 287/575, 60 HZ | M51C0325-W | M51C0625-W | M52C0725-W | .22/.11 | 1.54/.77 |
| 115/230, 50 HZ | M51C0328-W | M51C0628-W | M52C0728-W | .45/.22 | 3.27/1.64 |
| 230/460, 50 HZ | M51C0329-W | M51C0629-W | M52C0729-W | .24/.12 | 1.76/.88 |

Double C-Face Power-Off Brakes

M Series AC Coupler Brakes with NEMA 2 Housing Aluminum Head and Cover 56,700 NEMA 2

Stearns®

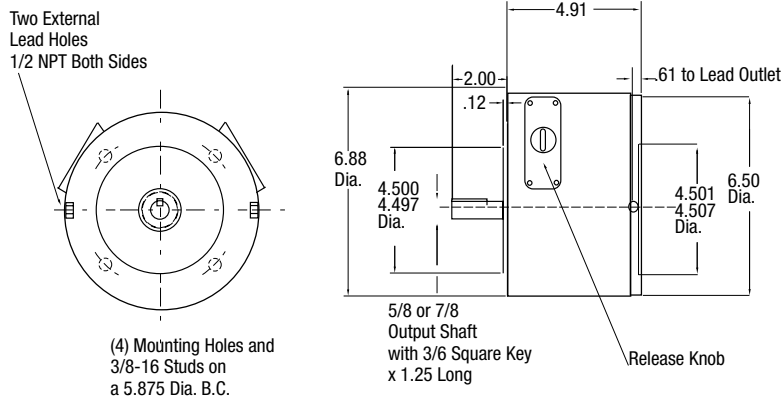

Warner UNIBRAKE®

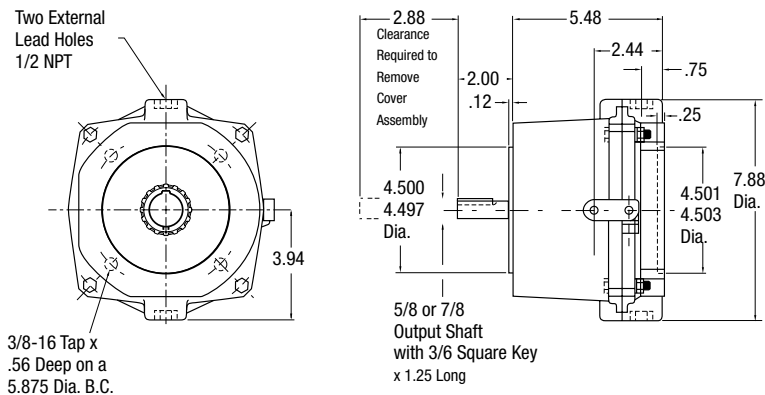

UNIBRAKE® Interchange

| Stearns® Part Number | Warner Electric Replacement | Stearns® Part Number | Warner Electric Replacement | Stearns® Part Number | Warner Electric Replacement |
|-------------------------|--------------------------------|-------------------------|--------------------------------|-------------------------|--------------------------------|
| 1-056-711-05-NF | M51A0325-W | 1-056-721-05-NF | M51A0625-W | 1-056-731-05-NF | M52A0725-W |
| 1-056-711-05-OF | M51A0328-W | 1-056-721-05-OF | M51A0628-W | 1-056-731-05-OF | M52A0728-W |
| 1-056-711-05-PF | M51A0321-W | 1-056-721-05-PF | M51A0621-W | 1-056-731-05-PF | M52A0721-W |
| 1-056-711-05-QF | M51A0324-W | 1-056-721-05-QF | M51A0624-W | 1-056-731-05-QF | M52A0724-W |
| 1-056-711-07-NF | M51C0325-W | 1-056-721-07-NF | M51C0625-W | 1-056-731-07-NF | M52C0725-W |
| 1-056-711-07-OF | M51C0328-W | 1-056-721-07-OF | M51C0628-W | 1-056-731-07-OF | M52C0728-W |
| 1-056-711-07-PF | M51C0321-W | 1-056-721-07-PF | M51C0621-W | 1-056-731-07-PF | M52C0721-W |
| 1-056-711-07-QF | M51C0324-W | 1-056-721-07-QF | M51C0624-W | 1-056-731-07-QF | M52C0724-W |

Double C-Face Power-Off Brakes

M Series DC Coupler Brakes with NEMA 2 Housing

Aluminum Head and Cover

56,700 NEMA 2



The Double C-Face Brake is designed for use as a coupler between standard C-Face motors and C-Face gear reducers.

Features:

- External manual release lever
- Totally enclosed construction
- Torque adjustable from full-rated torque down to 50%
- DC coils to provide fast release times and easy wiring

Brake Part Numbers

Technical Data

| Coil Voltage | 3 ft. lb. Brakes (1 Disc) | 6 ft. lb. Brakes (2 Disc) | 10 ft. lb. Brakes (3 Discs) | Current Holding Amps | Resistance Ohms |
|---------------------------------------|---------------------------------|---------------------------------|-----------------------------------|-------------------------|--------------------|
| 5/8 Bore Shaft and Hub (56C) | | | | | |
| 24 VDC | M51A032Y-W | M52A062Y-W | M53A072Y-W | .91 | 26.4 |
| 90 VDC | M51A032X-W | M52A062X-W | M53A072X-W | .25 | 365 |
| 7/8 Bore Shaft and Hub (145TC) | | | | | |
| 24 VDC | M51C032Y-W | M52C062Y-W | M53C072Y-W | .91 | 26.4 |
| 90 VDC | M51C032X-W | M52C062X-W | M53C072X-W | .25 | 365 |

Double C-Face Power-Off Brakes

M Series DC Coupler Brakes with NEMA 2 Housing Aluminum Head and Cover

56,700 NEMA 2

Stearns®

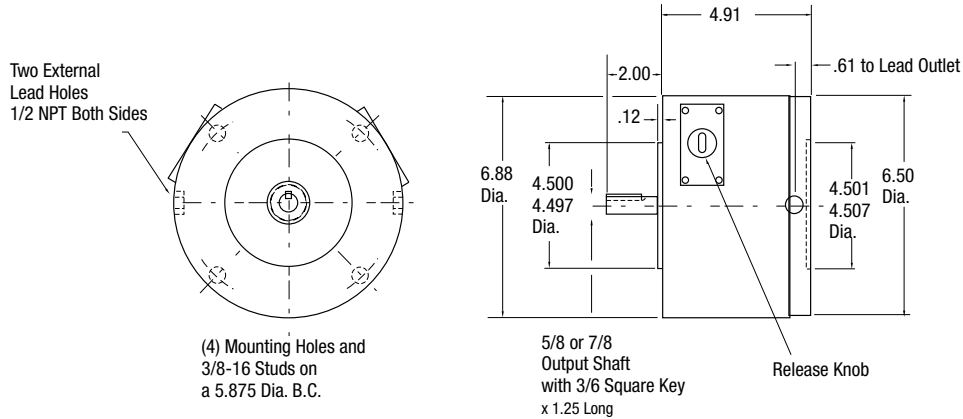

Warner UNIBRAKE®

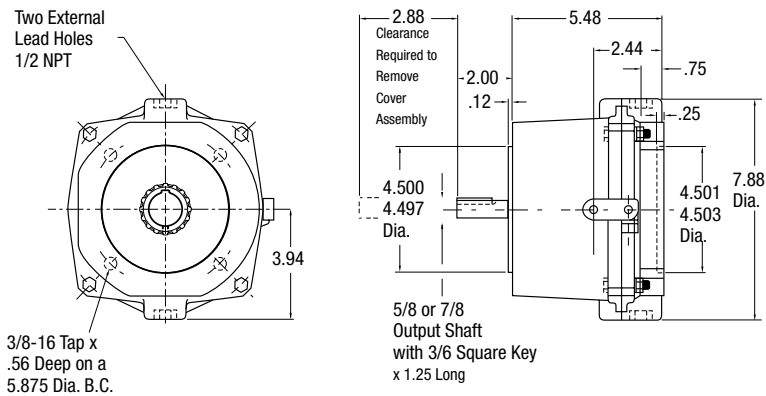

UNIBRAKE® Interchange

| Stearns® Part Number | Warner Electric Replacement |
|-------------------------|--------------------------------|
| 1-056-711-05-UF | M51A032Y-W |
| 1-056-711-05-XF | M51A032X-W |
| 1-056-711-07-UF | M51C032Y-W |
| 1-056-711-07-XF | M51C032X-W |
| 1-056-721-05-UF | M52A062Y-W |
| 1-056-721-05-XF | M52A062X-W |
| 1-056-721-07-UF | M52C062Y-W |
| 1-056-721-07-XF | M52C062X-W |
| 1-056-731-05-UF | M53A072Y-W |
| 1-056-731-05-XF | M53A072X-W |
| 1-056-731-07-UF | M53C072Y-W |
| 1-056-731-07-XF | M53C072X-W |

The Power Of One, The Strength Of Many.

OTHER PRODUCT SOLUTIONS FROM
ALTRA INDUSTRIAL MOTION

WWW.ALTRAMOTION.COM

Our comprehensive product offerings include various types of clutches and brakes, overrunning clutches, engineered bearing assemblies, gearing and gear motors along with linear products, belted drives, couplings and limit switches. With thousands of product solutions available, Altra provides true single source convenience while meeting specific customer requirements. Many major OEMs and end users prefer Altra products as their No. 1 choice for performance and reliability.



ELECTRIC CLUTCHES AND BRAKES

Inertia Dynamics
Matrix
Stromag
Warner Electric



HEAVY DUTY CLUTCHES AND BRAKES

Industrial Clutch
Stromag
Svendborg Brakes
Twiflex
Wichita Clutch

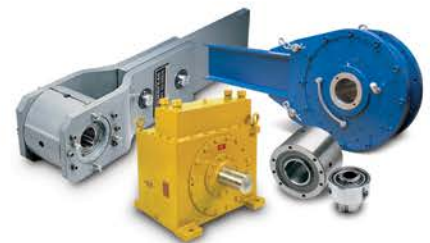

OVERRUNNING CLUTCHES

Formsprag Clutch
Marland Clutch
Stieber



ENGINEERED COUPLINGS AND UNIVERSAL JOINTS

Ameridrives
Bibby Turboflex
Guardian Couplings
Huco
Lamiflex Couplings
Stromag
TB Wood's



GEAR DRIVES

Bauer Gear Motor
Boston Gear
Delroyd Worm Gear
Nuttall Gear



GEAR MOTORS

Bauer Gear Motor



POWER TRANSMISSION COMPONENTS

LINEAR ACTUATORS AND CONTROLS

Warner Linear



ENGINEERED BEARING ASSEMBLIES

Kilian



AIR MOTORS

Huco



BELTED DRIVES AND SHEAVES

TB Wood's



GEARED CAM LIMIT SWITCHES

Stromag

Warner Electric Facilities

North America

USA

31 Industrial Park Road
New Hartford, CT 06057 - USA
860-379-1252

*Electromagnetic Clutches
and Brakes*

449 Gardner Street
South Beloit, IL 61080 - USA
815-389-3771

4578 East Park 30 Drive
Columbia City, IN 46725 - USA
260-244-6183

*Precision Electric Coils and
Electromagnetic Clutches and
Brakes*

Customer Service

1-800-825-6544

Application Support

1-800-825-9050

Europe

France

7, rue Champfleu, B.P. 20095
St Barthelemy d'Anjou - France
+33 (0)2 41 21 24 24

*Electromagnetic Clutches
and Brakes*

Customer Service

+33 (0)2 41 21 24 76

Application Support

+33 (0) 2 41 21 24 24

Asia Pacific

Australia

+61 2 9894 0133

China

+86 21 5169-9255

Hong Kong

+852 2615 9313

Singapore

+65 6487 4464

Taiwan

+886 2 2577 8156

Thailand

+66 2322 5527

The Brands of Altra Industrial Motion

Couplings

Ameridrives
www.ameridrives.com

Bibby Turbobox
www.bibbyturbobox.com

Guardian Couplings
www.guardiancouplings.com

Huco
www.huco.com

Lamiflex Couplings
www.lamiflexcouplings.com

Stromag
www.stromag.com

TB Wood's
www.tbwoods.com

Geared Cam Limit Switches

Stromag
www.stromag.com

Electric Clutches & Brakes

Inertia Dynamics
www.idicb.com

Matrix
www.matrix-international.com

Stromag
www.stromag.com

Warner Electric
www.warnerelectric.com

Linear Products

Warner Linear
www.warnerlinear.com

Engineered Bearing Assemblies

Kilian
www.kilianbearings.com

Heavy Duty Clutches & Brakes

Industrial Clutch
www.indclutch.com

Twiflex
www.twiflex.com

Stromag
www.stromag.com

Svendborg Brakes
www.svendborg-brakes.com

Wichita Clutch
www.wichitaclutch.com

Belted Drives

TB Wood's
www.tbwoods.com

Gearing

Bauer Gear Motor
www.bauergears.com

Boston Gear
www.bostongear.com

Delroyd Worm Gear
www.delroyd.com

Nuttall Gear
www.nuttallgear.com

Overrunning Clutches

Formsprag Clutch
www.formsprag.com

Marland Clutch
www.marland.com

Stieber
www.stieberclutch.com

Neither the accuracy nor completeness of the information contained in this publication is guaranteed by the company and may be subject to change in its sole discretion. The operating and performance characteristics of these products may vary depending on the application, installation, operating conditions and environmental factors. The company's terms and conditions of sale can be viewed at <http://www.altramotion.com/terms-and-conditions/sales-terms-and-conditions>. These terms and conditions apply to any person who may buy, acquire or use a product referred to herein, including any person who buys from a licensed distributor of these branded products.

©2018 by Warner Electric LLC. All rights reserved. All trademarks in this publication are the sole and exclusive property of Warner Electric LLC or one of its affiliated companies.